

TIMKEN**The Timken Company**

4500 Mt Pleasant St. NW

N. Canton, OH 44720

Phone: (234) 262-3000**E-Mail:** CustomerCAD@timken.com • **Web site:** www.timken.com

Part Number 7210 BTN1/CN, Timken® Single Row Angular Contact Ball Bearings (7200, 7300)

Timken® angular contact ball bearings are designed for combination radial and axial loading. Single-row bearings have high thrust capacity in one direction. Some single-row bearings are specifically designed for duplex mounting in sets for maximum performance.

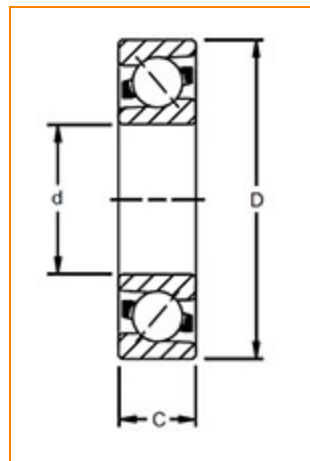

[Dimensions](#) | [Basic Load Ratings](#) | [Factors](#) | [Specifications](#) | [Abutment and Fillet Dimensions](#)

Dimensions

d - Bore	50.00 mm 1.9685 in
D - Outer Diameter	90.00 mm 3.5433 in
Bearing Width	20.00 mm 0.7874 in
Contact Angle	40 °

Basic Load Ratings



C0 - Static Radial Rating

28600 N
6428 lbf

C1 ISO - Dynamic Radial Rating	37500 N 8429 lbf
---------------------------------------	---------------------

Factors

Limiting Speed (Grease)	6700 rpm
--------------------------------	----------

Limiting Speed (Oil)	9000 rpm
-----------------------------	----------

Specifications

Ball Type	STEEL
------------------	-------

Cage Type	Molded
------------------	--------

Cage Material	Polyamide
----------------------	-----------

Bearing Weight	0.47 Kg 1.036 lb
-----------------------	---------------------

Design Units	METRIC
---------------------	--------

R - Inner Ring "Touch" Radius	0.6
--------------------------------------	-----

r - Outer Ring "Touch" Radius	0.6
--------------------------------------	-----

Features	Open
-----------------	------

Abutment and Fillet Dimensions

R - Inner Ring "To Clear" Radius¹	0.60 mm 0.024 in
---	---------------------

r - Outer Ring "To Clear" Radius²	0.60 mm 0.024 in
---	---------------------

da - Inner Ring Backing Diameter	57.0 mm 2.244 in
---	---------------------

Da - Outer Ring Backing	83.0 mm
--------------------------------	---------

Diameter

3.268 in

- ¹ Maximum housing fillet radius that bearing corners will clear.
- ² Maximum shaft fillet radius that bearing corners will clear.

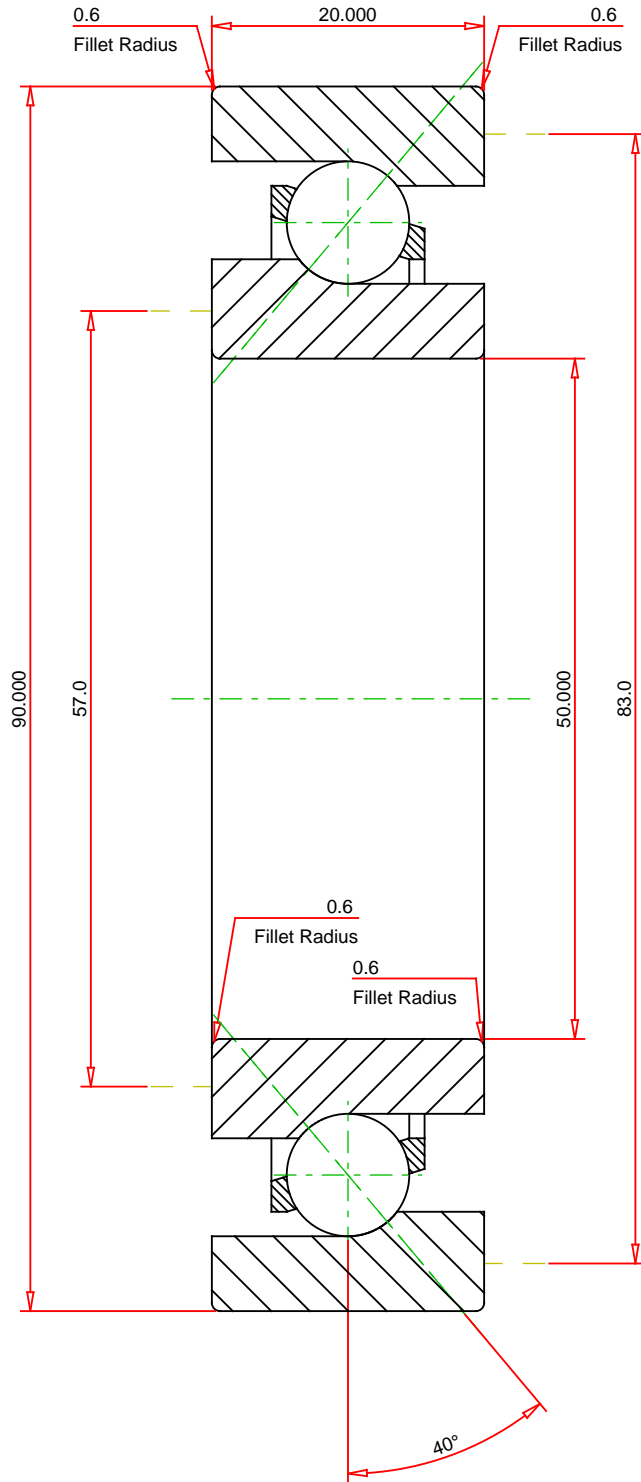

METRIC UNITS

Number of Balls Per Row 15
 Bearing Weight 0.470 kg

TIMKEN®

7210 BTN1/CN
 Timken® Single Row Angular Contact Ball Bearings
 (7200, 7300)

THE TIMKEN COMPANY
 NORTH CANTON, OHIO USA

Dynamic Radial Rating 37500 N
 Static Radial Rating 28600 N

Every reasonable effort has been made to ensure the accuracy of the information contained in this writing, but no liability is accepted for errors, omissions or for any other reason.

FOR DISCUSSION ONLY